

Road to School

Highway Road

Road to Pelrithang

Road to Gelephu

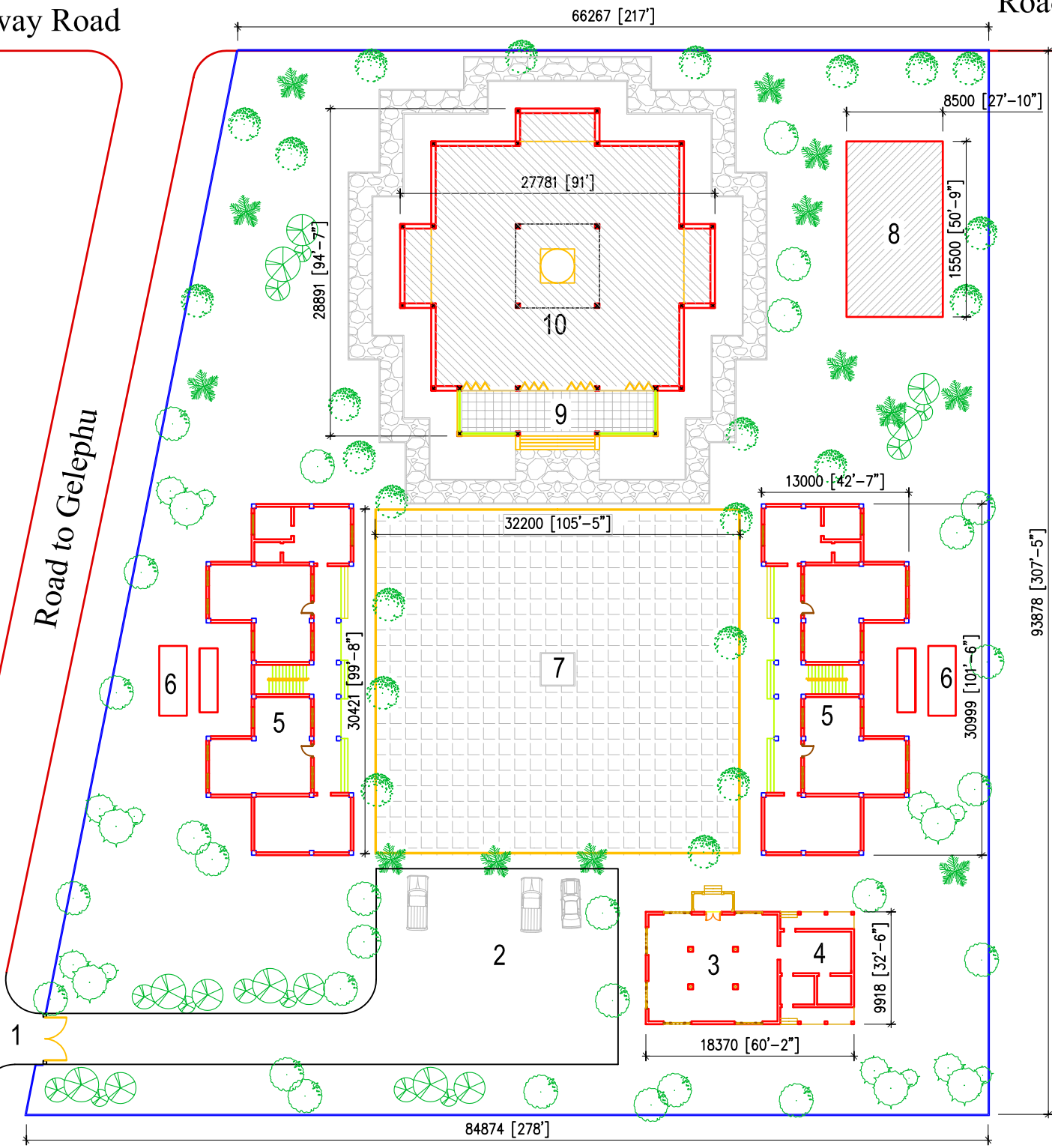

LEGEND

- 1 ENTRY
- 2 PARKING
- 3 DINING HALL
- 4 KITCHEN
- 5 DRASHA (CLASS/ROOMS)
- 6 WASH AREAS
- 7 DOSHE/COURTYARD
- 8 LAM'S RESIDENCE
- 9 GORIKHA
- 10 MAIN LHAKHANG

DATE	REVISION DETAILS	SIGN

PROPOSED DESIGN OF PEMA YOEDLING DRATSHANG, PELRITHANG, GELEPHU

DRAWING	REVISION SUFFIX
OVERALL-SITE-PLAN	
gandhara designs, pb: 882, thimphu, bhutan. ph: 325776 E-mail: gandhara@druknet.bt	

NOTES
 - ALL DIMENSIONS ARE IN MILLIMETERS UNLESS SPECIFIED OTHERWISE
 - ALL RELATIVE LEVELS ARE IN METERS UNLESS SPECIFIED OTHERWISE
 - ALL DIMENSIONS MEASURE UNFINISHED SURFACES UNLESS SPECIFIED OTHERWISE
 - ALL DIMENSIONS ARE TO BE READ AND NOT SCALED OFF
 - ANY DISCREPANCY IN DRAWING IS TO BE BROUGHT TO THE IMMEDIATE NOTICE OF THE CONSULTANTS/SUPERVISION TEAM
 - MINOR ADJUSTMENTS NEED TO BE CARRIED OUT ON SITE TO MATCH WITH EXISTING BUILDING

ARCHITECTS	DRAWN BY	DATE
gandhara designs	PEM-G.	28/05/06
SIGN	CHECKED BY	SCALE
	D.P.	1:500

NORTH	DRAWING NO
	GD/2006
	AD-01